

# Romsey Rag

VOLUME: 42 | EDITION: 07 | AUGUST 2024

**1984**  
FIRST EDITION  
REPRINT INSIDE  
**SEE PAGE 19**

*Romsey's*

## WHOLE TOWN GARAGE

**S  
A  
L  
E**



**Saturday 14th September**

**8am - 12:30pm**

Register to be part of our Romsey  
Whole Town Garage Sale! Start collecting NOW!

Call Romsey Neighbourhood House on 5429 6724 to make your  
booking or follow the link/ QR code below to register online.

**<https://bit.ly/RNHGarageSale2024>**

**This is without doubt the biggest town garage sale in the  
district!** Maps will sell for \$5 on the day 8am - 12.30pm  
at Romsey Hub

ROMSEY   
Neighbourhood House



# PICKLEBALL

is now in  
ROMSEY

TUESDAY MORNINGS 10 AM TO 11.30

SUNDAY MORNINGS 10 AM TO 11.30

## ROMSEY REC CENTRE



CALL TREVOR 0468 356 650 FOR DETAILS

## Our best customers come from our best customers.

Referring our services to  
your friends and family is  
the biggest compliment.



Talk to our team today

 Mortgage Choice - Woodend

p 5427 4262

w [MortgageChoice.com.au/peter.f.machell](http://MortgageChoice.com.au/peter.f.machell)

MortgageChoice Pty Ltd Australian Credit Licence 382869

## Get local. Support local.

- Booklets
- Flyers
- Invoice Books
- Magnets
- Stickers

Plus much more!



### Business Cards

From gloss to velvet, gold and metallic foiling, nearly anything is possible for your business card.



A: 3/87 Sydney St, Kilmore

J: (03) 5734 3344

✉: [info@nhprinting.com.au](mailto:info@nhprinting.com.au)

[nhprinting.com.au](http://nhprinting.com.au)



## Discover Better Health



- Acupuncture
- Myotherapy
- Counselling
- Kinesiology
- Chinese Medicine
- Remedial Massage
- Lymphatic Massage

### HEALTH SERVICES @ ROMSEY WELLNESS CENTRE

MONDAY 10am - 7.30pm	TUESDAY 9am - 3pm	WEDNESDAY Closed	THURSDAY 10am - 7.30pm	FRIDAY 9am - 3pm
-------------------------	----------------------	---------------------	---------------------------	---------------------



120 Main St Romsey (03) 5429 3610

[www.insymmetry.com.au](http://www.insymmetry.com.au)



## ROMSEY MECHANICS INSTITUTE

The Romsey Mechanics' Institute is on Crown Land and is owned by the people of Victoria. It is overseen by a volunteer Committee of Management (CoM) which answers to the Department of Energy, Environment & Climate Action (DECCA)



ESTABLISHED 1865

**POP-UP STORES:** Late in June the RMI hosted a pop-up socks, beanies and moccasins store for two days. Large numbers of the community headed down to 122 Main Street to get excellent value for their money. Sales were good and it looks like our stall holder will be back in the near future.

This time he is hoping to bring a mate who specialises in work wear. Please keep an eye out for news of these two pop-up stores returning to the RMI.

**REPAINTING THE MAIN HALL:** We mentioned last year that the CoM had hopes of sourcing funding to assist us to repaint the main hall. With community support we will be applying in July/August to the Bendigo Bank's Community Funding Scheme. We have had a very experienced painting company supply quotes and have already spoken with both the MRSC Heritage Consultant and a MRSC Town Planner to make sure that what we plan to do will fit in with the requirements of the Shire. We will soon be writing to DECCA to seek their approval for the works. Fingers crossed our application will be successful and we can continue the works to bring this "Grand Old Lady" back to her very best condition.

**BOOKINGS:** Over the last six weeks the hall has been busy hosting memorials, birthday parties, information sessions and our regular user groups. It is surprising to meet locals who wish to have a look through the hall with a view to booking an event and hear "I never knew this place was here."

If you would like to hold an event at a venue over the colder wetter months then the RMI might be just what you need. High quality projector, large motorised screen, plenty of tables and chairs and a very reliable heater.

**PO BOX 130, MOB: 0458 726 106, ABN: 99 340 024 758**

[presidentrmi@gmail.com](mailto:presidentrmi@gmail.com), [secretaryrmi@gmail.com](mailto:secretaryrmi@gmail.com), [rmibookings@gmail.com](mailto:rmibookings@gmail.com)

[www.romseymechanicsinstitute.com](http://www.romseymechanicsinstitute.com)

## AUGUST IN THE GARDEN

by Melanie Kinsey

We have escaped Victoria's cold and are currently enjoying the weak winter sun on Queensland's coast! I am enjoying the changing scenery from eucalypts and wattles one minute to Bangalow palms and giant bird-of-paradise the next! We have also been visiting different botanic gardens and significant trees along the way.

The one thing I have noticed is the change of weeds beside the road. We have gone from blackberries to lantana, thistles to giant devil's fig and gorse to tree tobacco. I learned at Burnley that a weed is 'a plant out of place'. What you love and struggle to keep alive might be a curse in another climate. I was amazed to find a specimen of the coral berry in the sub-tropical rainforest west of Brisbane. *Ardisia crenata* is sold in Victoria as an indoor plant and I have always admired its glossy green leaves and bunches of bright red berries. However, in the sub-tropics this plants shades out native seedlings thereby inhibiting regeneration of native plants. The following is a good reference if you want more information about not planting a potential weed in your garden <https://www.growmeinstead.com.au/>



We have also been tracking down trees on the significant tree register and were awed by a visit to a clump of three Antarctic Beech trees (*Nothofagus moorei*) near the Gold Coast which have been dated to about 2000 years old. How amazing is that? I think that's the oldest living thing I have ever seen. With moss covered, gnarled and contorted trunks they were a truly wondrous sight. We were also privileged to hear the rare Albert's lyrebird give a performance for 10 minutes while we stood beneath the rainforest canopy with breath held.

## Committee

### President:

Tony Lakey

### Treasurer:

Dianne Irvine

### Secretary:

Allan Irvine

### General Committee:

Shauna Martin

Sonia Martin

### Production Assistants & Proofreading:

Trish Dunn

Sue Kirkegard

Allan Irvine

Tony Lakey

Shauna Martin

### Distribution:

Allan & Dianne

John Evans

Margaret Lynch

**Romsey Rag**

ABN: 80 102 393 407  
INC A0102067K

**MARY-ANNE THOMAS MP**

# Artworks to Celebrate Significant Victorian Women

The Allan Labor Government is celebrating the role of women across Victoria with a new round of the Women's Public Art Program – to install six new public artworks honouring remarkable women.

Minister for Women Natalie Hutchins recently opened applications for the next round of the program. Of the almost 600 statues across Melbourne's public spaces, only around two per cent represent women, with most statues representing men or animals.

That's why the Labor Government is working to shift the dial on the public representation of women, investing a further \$1.2 million into the second round of the landmark Women's Public Art Program.

Aboriginal women are often invisible in public artworks, and this NAIDOC Week Auntie Pam Pedersen is highlighting the opportunity to recognise Aboriginal women through public art such as the sculpture of her mother, Lady Gladys Nicholls, at Parliament Gardens.

To apply, visit [www.vic.gov.au/victorian-womens-public-art-program](http://www.vic.gov.au/victorian-womens-public-art-program).



[www.theromseyrag.com.au](http://www.theromseyrag.com.au)

Community Newspaper Association of Victoria - the voice of the community

The Romsey Rag is proud a member of the CNAV. It is the peak body representing not-for-profit community newspapers across Victoria.

# WE ARE BACK!

## STALL HOLDERS NEEDED

**SUNDAY 11 AUGUST**

- PRODUCE
- CRAFT
- FOOD
- 2ND HAND GOODS
- GARAGE CLEANOUT

**RING US - EMAIL US**

**KEEP THE  
MARKET GOING**

# LANCEFIELD ROMSEY LIONS CLUB



**ROMSEY MARKET**

**CONTACT: 0456 797153**

**Lionsmarketromsey@gmail.com**

## What's On at Romsey Library in August 2024?

### ROMSEY LIBRARY MOVIE CLUB

- Where the Crawdads Sing (*Rated M*)  
Wednesday 14th August 10.30am – 1.00pm

A woman who raised herself in the marshes of the Deep South becomes a suspect in the murder of a man with whom she was once involved. Based on the book of the same name by Delia Owens.

Includes interval with tea and coffee provided.

Bookings required – head to [goldfieldslibraries.com](http://goldfieldslibraries.com) or phone us on 5429 3086.

### | Romsey Events

- *A Curious Circle*: Cardmaking Part 2  
Saturday 17th August 1.00pm – 4pm

Continue your cardmaking journey using rubber stamps, die-cuts, embellishments, scrapbooking paper and more to make your own greeting cards! Materials supplied.

Refreshments provided.

Bookings required – head to [goldfieldslibraries.com](http://goldfieldslibraries.com) or phone us on 5429 3086.

### | STEAM Lab

- Calling kids 7 years + for STEAM Lab!

Pop into the library and explore hands-on activities with fellow tinkerers over 4 Saturday morning sessions: Sat 10 August, Sat 17 August, Sat 24 August and Sat 31 August.

- Saturday 10 August -Strong structures

Build towers from different materials and see if they can withstand the force of a Nerf bullet!

- *Saturday 17 August*- Electric currents

Experiment with electronics by creating circuits on paper and creating sound with an electronics lab.

- *Saturday 24 August*- Un-Making

Pull things apart to see what they're made of and explore how they work!

- *Saturday 31 August*- Automata

Explore force and mechanics in motion!

### | Get involved with The Seed Library

In addition to borrowing books, DVDs and magazines from the library, you can now also borrow seeds! The Seed Library is supported by the Macedon Ranges Seed Savers who meet regularly to help sort, pack and label the seed packets. We are always looking for people to join us to help with the above tasks. We meet on the 4th Friday of the month at 10:30am in the library.

### | Using the library for work, study or a break from home

Romsey Library has free Wi-Fi, lounge area, quiet area for study or work and access to print, copy and scan services. If you are working and need to make a private phone call or conference call, we may be able to offer you a private space to do this. Please enquire about this at the Library desk or phone us on 54293086.

### PRINTING PRICES

- 20c per A4 single-sided page for Black & White and 50c per A4 single-sided page for Colour.
- 50c per A3 single-sided page for Black & White and \$1 per A3 single-sided page for Colour.

For families, we have our Lego table permanently set up in the children's area as well as our makerspace, The Creation Station. Here, kids can create and draw from the array of art and craft supplies available. This is available during opening hours and bookings are not required. We ask that children are supervised, and the area remains tidy ready to be enjoyed by others.

**The Macedon Ranges Suicide Prevention Action Group (MRSPAG) have recently launched a new integrative fitness, wellbeing, and community connection initiative called "Mindful Moves".**



This FREE program is designed to enhance community physical and mental well-being. The next session - "Effortless Meditation" - features meditation and mindfulness techniques which you can easily apply in your home.

**UPCOMING SESSION: EFFORTLESS MEDITATION**

- **Date:** Saturday, 3rd August  
**Time:** 10:00 AM - 12:00 PM  
**Location:** Kyneton Toyota Sports and Aquatic Centre

Mindful Moves is a 12-month campaign. Events are on the first Saturday of each month. Locations will rotate throughout the Macedon Ranges shire to be accessible to all.

Sessions are open to all and promote the benefits of physical fitness for mental health and wellbeing. It features low-impact circuit training led by volunteer Macedon Ranges fitness instructors passionate about improving mental health through physical fitness.

**KEY FEATURES:**

- **Inclusive:** Designed to suit people of all fitness levels and abilities.
- **Social Connection:** A fun, inclusive, supportive environment for social interaction.
- **Mental Health Discussions:** MRSPAG kicks off an event with discussion on local mental health and suicide prevention.
- **Healthy Food & Resources:** Healthy food options and details of local support services are available at the end of sessions.

Fitness instructors and personal trainers leading this campaign will complete Mental Health First Aid training through MRSPAG. This equips them with knowledge and skills to support clients' mental health needs.

Everyone is invited to join in to "Effortless Meditation" on 3rd August. Take this journey towards better physical and mental health. To book your FREE ticket, please visit <https://events.humanitix.com/mindful-moves-august>

We also seek expressions of interest from qualified personal trainers to facilitate the "Mindful Moves" campaign in the next year. Any local business interested in donating healthy food options will be greatly appreciated for such generosity and community spirit.

For more information or to be involved, please email: [info@mrspag.com.au](mailto:info@mrspag.com.au)

## Thanks for Your Donations

**Our new Op Shop is now up and running. Please take your donations to the Neighbourhood House at The Hub (not to the Op Shop) and don't forget that we are always looking for volunteers for the Op Shop and all the Neighbourhood House activities.**



## Landcare Week: 5-11 August

Happy Landcare Week! Council wishes to say thank you to our community for their support.

This annual celebration acknowledges Australians who are actively restoring, enhancing, and protecting the natural environment in their communities.

This year's campaign theme is Landcare Is For Everyone (L.I.F.E), encouraging people to get involved in their local Landcare or other community environmental groups.

Visit [mrsc.vic.gov.au/environment-groups](http://mrsc.vic.gov.au/environment-groups) to find your local environment group.

## WOODEND HANGING ROCK PETANQUE CLUB

**What a month we have had ! Winter is meant to be our season of rest. but no, not this month! From the very first Saturday, we had the first round of the Golden Boule Tournament, playing the Maldon Petanque Club, at the Old Racecourse here in Woodend. It was a bright sunny day and all members played well, with Woodend winning 9 out of the 12 games.**

Other clubs in the pool are the Ballarat Petanque Club, Smythesdale Petanque Club, Pyrenees Petanque Club from Avoca, Maldon Petanque club and Mount Macedon Petanque Club with every club playing each other over the course of five odd weeks. In this relaxed format it encourages our newer players to think about the rules and tactics and the etiquette of the game.

Our next tournament was against Maldon Club again on a bright sunny and chilly day!

This was our annual inter club challenge called The Rock and Goldfields Dig Challenge We managed to win the trophy this year, so, it was a well earned congratulations to Woodend. Our four, 3 game winners were Chris Turner, Rod Gell, Graham Cole and Maria Liew, who won the top award for our club with the highest delta, well done Maria !

Last Saturday, July 6th, a group of hardy players ventured to Ballarat, through fog and ice strewn roads to arrive in bright sunshine and play in the 3rd round of the Golden Boule Tournament. Unfortunately Ballarat were too strong for us by winning 16 games to 14.

And on July 14, Bastille day, took us to Hanging Rock to play our annual tournament.

We all rugged up, put the heaters on and snuggled up in the shelter with a friendly cup of wassail, made by Gary Richardson, to warm us up, because of course it's winter and always a chilly day at the Rock.

Thirty members gathered to play 1 game and then a warming cup of soup made by Rod Gell and Anne Browne and then another game, which then to lead us up to enjoy a delicious lunch catered for by our members. A french casserole by Carole Mee, Chris Turner and Louise Potter and of course a delicious sweet of chocolate mousse by Cassie Simmons.

The joint winners of the day were Lola Sandy and Clive Potter who took home the winners prize of chocolates and wine. A trivia game with a french theme followed with much laughter, at our limited knowledge of anything french ! With winners, Nina, Ruth, David, Marni, Krista and Gary taking home a prize !

So, if any of this sounds like you would like to join in please don't hesitate to email the President Louise Potter at [president@tpetanqueattherock.com.au](mailto:president@tpetanqueattherock.com.au)

Next month, on the third weekend of August we will be travelling to Echuca for the weekend.

If you would like to join in the fun of the weekend please email the president.



## ROMSEY LANCEFIELD SENIOR CITIZENS - BENDIGO BANK BUS TRIPS

### **Our Christmas in July luncheon was great fun up at Kyneton RSL**

Our next trip will be in September.

On **Tuesday 10th of September** we will visit the **Spanner Man Sculpture Gardens** in Boort. We will visit the property near Boort and view the wonderful sculptures that the late John Piccoli has made out of spanners.

There are sculptures of a family of deer, a shearer, a pair of fighting stallions, a mallee bull and many more. Cost will be \$50, which includes lunch.

Look out for more details in next month's report on pick up times or give Helen or Jan (*on the numbers below*) a ring for more information. Remember, we meet every Monday at the rear of the Romsey Mechanics Institute for lunch (\$10), a chat and a game of cards—everyone is more than welcome.

For further information contact Helen on 0409 064 303 or Jan on 0408 338 759.

**| Hope to see you soon.**

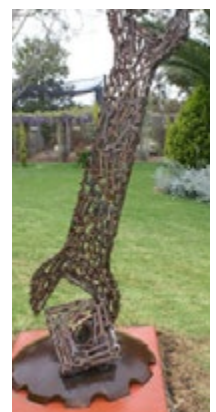



# CWA is a Volunteer Organisation

**Hope everyone is keeping warm as winter has really hit with these cold days, thought we would put in a recipe for these chilly days and nights.**

## **COTTAGE PIE SERVES 4**

### **INGREDIENTS**

- 1 kg mince 1 tablespoon oil
- 2 onions chopped 1 ½ tablespoons tomato paste
- 1 tablespoon gravy powder 2 teaspoons curry powder
- 1 cup water salt and pepper to taste
- Grated parmesan for sprinkling chopped parsley to garnish
- Topping
- 1.5kg potatoes cooked and mashed add ½ cup milk and dollop of butter to mash.

### **METHOD**

1. In a large saucepan brown the mince in oil over med heat, stirring breaking up the mince. Add onions cook for 5 mins until soft add the tom paste, gravy powder and curry powder water and salt and pepper. Stir well cover and simmer for 15 mins add little more water if looks to dry.
2. Mash the potatoes with milk and butter.
3. Place the mince mixture into a casserole dish top with mashed potato, sprinkle on the parmesan.
4. Bake in mod oven 180c until browned on top. 30-40 mins.
5. Sprinkle with parsley and serve.

### **FOR ANY FURTHER INFORMATION PLEASE CALL:**

**PRESIDENT:** Dianne Purtill, M: 0409 214 520

**SECRETARY:** Wendy Foster, M: 0409175 667 oemail: cwaromsey@gmail.com

CWA is not just for older women; it is for women of any age wanting to be involved in their local community and also be connected to a world-wide organisation of friendship and community care. We have a lot of fun and laughs while being creative and raising funds for community projects.

### **C.W.A. 2022 STATE THEMES:**

**THEME:** Sharing, fun and friendship.

**PRODUCT/RESOURCE:** Australian grown potatoes and Australian potato products.

**COUNTRY OF STUDY:** Malaysia.

**THANKSGIVING FUN:** Free 3D hands – Research and development of 3D hands.

**STATE PROJECT:** CWA of Vic. Inc. IT and Systems Upgrade and Maintenance.

**SOCIAL ISSUES FOCUS:** Safe Homes for All.

## **Immunisations on again**

**Council is offering FREE childhood immunisations under the National Immunisation Program.**

Mark your calendars for our bi-monthly sessions: catch us in Gisborne, Kyneton and Woodend on the first Thursday, and in Riddells Creek and Romsey on the third Tuesday.

Plus, don't forget – we're also providing FREE flu vaccines to children under five.

To view our timetable and make a booking go to [mrc.vic.gov.au/immunisations](http://mrc.vic.gov.au/immunisations).

Let's keep our kids healthy and thriving together!

## **Romsey Has a Paralympian in Paris**

**Patrick French is a Romsey local who is a very keen archer and is a proud member of the Australian Olympic Team.**

Patrick is an Australian record holder and a member of the Diamond Valley Archers.

We wish him well.





# G'day



## COOKING WITH PETER RUSSELL-CLARKE

### G'DAY,

"Nuts to you, too!" An American expression not used in Australia as often as 'Stone the crows!' or "Starve the lizards!"

And nuts aren't eaten as often as I believe they should be.

Instead of snacking on milk chocolate (*dark chocolate is OK, as long as you only eat one or two squares of it daily, and those squares contain at least 60% cocoa*) - but back to nuts. As a general rule, nuts contain protein, omega and fatty acids, vitamin E, potassium, calcium, iron, magnesium, zinc and selenium - different varieties of nuts contain different amounts of the goodies! Therefore it's not a bad idea to buy mixed nuts - many varieties and mix them yourself.

Anyway, here's an idea which I've put together which I think is good-oh. And not just for snacking. Try it with Natural Greek Yoghurt or just about anything else.

## BLOODY GOOD NUTS, ETC.

### INGREDIENTS

- 1 egg white
- 2 cups mixed nuts, such as Brazil nuts, walnuts, pecans and almonds
- 1/2 cup pepitas (*pumpkin seeds*)
- 1 tablespoon brown sugar
- 2 teaspoons ground ginger
- 1/2 teaspoon ground nutmeg
- 1/2 cup dried cranberries.

### METHOD

- Lightly whisk the egg white in a large bowl then add the nuts and pumpkin seeds. Toss to coat them well then stir in the brown sugar, ginger and nutmeg. When all is blended well, stir in the cranberries. Spread the mixture over two ungreased baking trays then bake for about 20 minutes in the oven pre-heated to 180 deg.C.

## ROMSEY LANCEFIELD ROTARY CLUB Inc

### Romsey Lancefield AVENUE of HONOUR and FEDERAL GOVERNMENT GRANT

The Romsey Lancefield Rotary Club President Dr Diane Powell and her partner Dr Greg Powell (*Rotarian Past President*) met with the Honourable Rob Mitchell (*MP*) Federal Member for McEwen at The Lost Watering Hole (*Lancefield*) to be notified of the Rotary Club's success in the 2023-2024 Volunteer Small Grants Program.

This Grant will assist to provide safety equipment and tools needed for the upkeep of this avenue, and help a new major project developing in the next two years along the track.

The Avenue of Honour is a joint effort commenced in 2008 between the Romsey Lancefield Rotary Club and the RSL Romsey Lancefield - subbranch. Thank you to all Rotarians, the RSL Romsey Lancefield - subbranch and locals = individuals and local schools - for your support on this Remembrance cause.

# Rotary

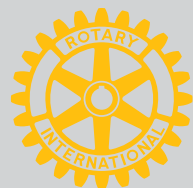

The Romsey Lancefield Rotary Club Inc. meets every fortnight on Thursdays (7 pm - 9 pm) at Soltan Pepper Restaurant or The Lodge (*Lancefield*), Community members interested in becoming Rotarians are very welcome to join us.

For further information please contact our Club Secretary - Anne Collins via email [anne.collins@outlook.com.au](mailto:anne.collins@outlook.com.au) or phone: 0411 097 187

**Dr Greg Powell**  
(Past President)

The Romsey Lancefield Rotary Club Inc.



**Romsey**  
**AUTO SPARES**

7 Park Lane Romsey

54295114

Open  
Monday to Friday  
9am - 5.30pm  
Saturday  
9am - 1pm

For all your Spare Parts and Auto Needs  
romseyautospare@outlook.com



### LANCEFIELD CEMETERY OPEN DAY

#### Open Day and Father's Day remembrance at Lancefield Cemetery will be

held at the rotunda rose garden on Sunday 1st of September between 10.00am & 1.00pm.

Visit the Cemetery and have a cuppa with the Trust members who will be there to discuss any enquiries you may have and provide information about the cemetery.

We look forward to seeing you there, if you have any enquiries call our Secretary on 0477 092 946 or email lancefieldcemeterytrust@gmail.com.

Romsey & Lancefield Districts Historical Society Inc.



P O Box 101  
LANCEFIELD 3435

Website: [www.romseylancefieldhistorical.org.au](http://www.romseylancefieldhistorical.org.au)

Email: lancefieldcourthouse@gmail.com

## Annual General Meeting

**3pm Sunday 18th of August 2024**

At Lancefield courthouse  
55 Main Road Lancefield

*All welcome*

**Phone Secretary 0402 248 540**



# Trees... They Need us and We Need Them

**Our National Tree Planting Day on Sunday, July 28 reminds us of the importance of trees. Trees are vital to our ecosystems; they sustain the life of insects, reptiles, birds and other animals. They draw down on carbon, act as windbreaks and provide shelter and shade.**



Since our inception in 1989 Deep Creek Landcare Group has planted thousands of indigenous trees, shrubs and grasses along our roads and waterways and private properties in our area around Lancefield, Romsey and Monegeetta. We are always on the lookout for opportunities to be "nature positive" by enhancing biodiversity.

If planting a significant number of trees, shrubs or grasses it is substantially cheaper to buy seedlings. DCLG is able to supply a range of local seedlings from \$35 per box of 48 plants, give expert advice regarding selection and planting and the availability of government grants. Orders need to be in by the end of September so that we can propagate from indigenous seeds supplied by The Tree Project.

As part of the Upper Deep Creek Landcare Network we are also involved in a couple of local biolink projects. Biolinks are areas of vegetation or habitat, such as waterways or paddock trees that form connections or wildlife corridors to enable fauna to move freely throughout the landscape to feed, breed and seek protection. Biolinks also contribute to the movement of plants through seed and pollen dispersal, leading to greater resilience and genetic diversity.

The Mount William Range Biolink and Deep Creek Biolink are two of six priority biolink areas identified in Macedon Ranges Shire Council's Biodiversity Strategy 2018. The Mount William Range Biolink Project aims to connect existing remnant vegetation along the Mount William range, through a combination of management actions. These actions include, but are not limited to, fencing, revegetation, pest, plant and animal control and installing nesting boxes. The Deep Creek Biolink project has similar objectives along Deep Creek.

On Friday, July 26 we celebrated School National Tree Day with Romsey P.S. We will be adding a range of small, local flowers to enhance the earlier plantings of local trees and shrubs along the southern boundary of the school. In addition, our Junior Landcare Facilitator (*Emma Stevens*) is organising a planting day at Lancefield Park with Lancefield P.S and St Marys P.S on Friday, September 13.

Deep Creek Landcare Group has nesting boxes for bats, birds and phascogales for sale from \$30. We also have Myna bird traps to lend out. Annual Landcare membership is \$20 per family. You can follow us on Facebook, catch us at the Lancefield Farmer's Market from September, contact our President, Phil Severs (*0476 324 000*) or attend our monthly meetings in the Lancefield Mechanics Hall. We would love to see you!

## Village Connect coffee catch-ups

**Are you 55 years or older, residing in the Macedon Ranges and looking to connect with others in the shire? Council's one-hour Village Connect coffee gatherings welcome new residents, individuals living alone, or those navigating life changes who are looking to strengthen connections with other like-minded individuals in our community.**

The next round of coffee catch-ups are from 10:30-11:30am as follows:

- 6 August - Riddells Creek
- 8 August - Lancefield

- 20 August - Kyneton
- 15 August - Gisborne

Bookings are essential. Visit: [mrsc.vic.gov.au/village-connect](http://mrsc.vic.gov.au/village-connect) or call 5422 0333.

## TEAM NEWS!

It's been a big month for team news within our two branches! In June, we said farewell to Tanae Bannan, who took on a fabulous role as Operations Manager at the Riddell District Football Netball League.

Karen Baloh, our long standing Customer Relationship Officer in Romsey has retired. We sincerely thank her for her contributions over the years and wish her well for this next chapter in life!

Matthew Richardson, who came to us straight out of school on our traineeship program has taken on a new role at Bendigo Bank Head Office. Matt has worked in the Romsey branch for almost 4 years and has become an integral part of the team. Congratulations Matt on your move to Head Office – the staff, customers and town will miss you.

We have also welcomed two new Customer Service Officers to the team – Wendy Hazon and Mandy Andrews.

Mandy has lived in Lancefield for 20 years, has two grown children and 3 grandchildren, with a 4th due any day now. Prior to joining our team, she was lucky enough to work in a variety of industries in and around Lancefield.

Wendy moved to the Macedon Ranges with her eldest daughter 7 years ago. She has set up a home with a menagerie of animals, including horses, dogs, cats and chooks. Wendy says she loves living in this area and find the locals very friendly and helpful.

We encourage everyone to drop by and meet Wendy and Mandy. Your patience as they settle in is greatly appreciated.

## COMMUNITY INVESTMENT AT AN ALL TIME HIGH

As the end of financial year has now been and gone, we can announce our Community Investment Program contributions for our 2023-24 program. We're thrilled to report that thanks to your better banking, we paid over \$500,000 in grants, sponsorships, and scholarships for our local community, significantly exceeding the previous year's contributions!

## GRANTS AND SPONSORSHIP APPLICATIONS OPEN

Thank you to everyone that joined us at our Community Investment Program information session in July. It's always encouraging to see so many committed community members brave the weather on a dreary July evening to learn more about our grant application process.

Applications for grants and sponsorships, both large and small, are now open via our new online application platform: <https://communitybanklancefieldromsey.smartygrants.com.au>

## APPLICATIONS CLOSE SUNDAY 25 AUGUST 2024.

To discuss your project or to make sure your community group is registered to receive our Community Investment Program information, email Lauren Harrison via [cip@lrcfsl.com.au](mailto:cip@lrcfsl.com.au). We look forward to receiving your applications for our Community Investment Program.

**Supporting your local community**

Community Bank - Romsey 5429 5526





Community Bank · Lancefield and Romsey

APPLY NOW

# Lancefield and Romsey Community Investment Program

Support for your organisation when it needs it most.

Applications open Monday 22 July and close 25 August 2024.

For more information email [cip@lrcfsl.com.au](mailto:cip@lrcfsl.com.au) or follow the link below.

[communitybanklancefieldromsey.smartygrants.com.au](https://communitybanklancefieldromsey.smartygrants.com.au)



Community Enterprise  
Foundation™

The Lancefield Community Grants Program is a management account of the Community Enterprise Charitable Fund ABN 12 102 649 968 (the Fund), The Bendigo Centre, Bendigo VIC 3550. Sandhurst Trustees Limited ABN 16 004 030 737 AFSL 237906, a subsidiary of Bendigo and Adelaide Bank Limited ABN 11 068 049 178, AFSL 237879, is the trustee of the Fund. OUT\_38833281, 15/07/2024



**EMRBATA'S VISION IS:** A vibrant, collaborative and prosperous eastern corridor community which enhances liveability in the region.

**FACEBOOK:**  
Eastern Macedon Ranges - Business and Living  
**EMRBATA MEMBERSHIP:**  
<https://easternmacedonranges.au/emrbata>  
**EMAIL:**  
[contact@macedonranges.au](mailto:contact@macedonranges.au)

# Romsey Town Centre Action Plan UPDATE

There is excitement building amongst Romsey Town Centre Action Team members as the Signage, Lighting and Murals working groups finalise their project proposals to present to the broader Town Centre Action Team. Each of the groups has been working with the appropriate stakeholders – private property owners, business operators, Macedon Ranges Shire Council and Regional Roads Victoria – to develop concepts for these town centre-focused projects. In addition, the Action Team is also exploring funding support options that may be appropriate to support these initial projects. The Romsey Town Centre Action Plan includes a vast array of “actions”, some of which do not require massive amounts of money for implementation. As the year progresses, new items will be identified in the Town Centre Action Plan to be developed into “projects”.



Updates will be posted on Facebook (<https://www.facebook.com/RomseyAction>) and in the Romsey Rag. EMRBATA is committed to supporting the Romsey Town Centre Action Team to reinvigorate Romsey's town centre.

The Romsey Town Centre Vision and Action Plan document can be viewed in full at: [https://easternmacedonranges.au/s/240508\\_Romsey-action-plan-FINAL2.pdf](https://easternmacedonranges.au/s/240508_Romsey-action-plan-FINAL2.pdf)

**FOR FURTHER INFORMATION, EMAIL:** [contact@easternmacedonranges.au](mailto:contact@easternmacedonranges.au)

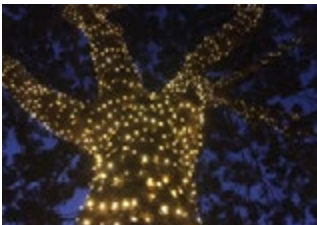

**LOST WATERING HOLE**  
THE LANCEFIELD BREWERY

*Hump Day*

**DUMPLINGS**



8-10 THE CRESCENT, LANCEFIELD, VIC 3435.

**\$15**

---

**FOR 10 DUMPLINGS WITH DUMPLING SOUP**

---

**WEDNESDAYS FROM 5PM**

---

[WWW.LOSTWATERINGHOLE.COM](http://WWW.LOSTWATERINGHOLE.COM)



SEVI releases the Southern Boobook Owl.



Park Lane, Romsey  
(PO Box 200, Romsey 3434)

**PRESIDENT:** 0417 088 891

**SECRETARY:** 0400 768 040

mail@romseygolfclub.net

www.romseygolfclub.net

## ROMSEY GOLF CLUB REPORT

### Romsey Park wildlife

RGC Greens' Keeper, Steve "Sevi" Wilkins noticed a small bird on the ground below one of the older gum trees. He picked it up and took it home. Once home he and wife Sue, took it to Wildlife Care in Wallan. The bird was a Southern Bobook Owl. It had apparently flown into a branch and was concussed. A few days of TLC and Sevi and Sue were able to bring it home. The bird was released and flew quickly into one of the nearby trees. Sevi has since seen it and its pair ensconded in a natural hollow in one of the Park's oldest trees. In recent years the club has built and installed over 30 nesting boxes. These are for smaller birds (*Tree Creepers, Striated & Pardalotes*) and smaller mammals such as the (*phascogales & antechinus*)

### W. E. Tom 4BBB Shield

This shield is played during July and August, it is a team event. The qualifying round sees all pairs playing to get into the top eight. These eight pairs then play matchplay in the quarter and semi finals before the final on August 17th. It looks like the 2023 champions, Dylan Harris/Luke Lyons will not be able to defend the shield.

### Short Course

In early July Elaine Scanlon, Darlene Baker, Anthony Lakey (RGC) and Tristian Zito (*GolfAus*) walked the course and organised the layout for a Yellow, Short Course. This course is Par 72 for men and women and is 3,846m long. It may sound an easy course but handicapping sees a player off 18 on the blue course off 6 on the yellow course, a player of 2 or 3 on the blue will be +6 on the Yellow Course. Golf is very aware that the world is changing and people do not always have four hours for a round of golf. This short course will allow players to play a round but have it over and done with in around two to two and a half hours. Our thanks to Paul Green, John Freestone and Trevor Turnham who have worked together to prepare the new Yellow Tee Markers.

### Romsey Junior Football/Netball Vouchers

Every year, during school holidays, we have numerous younger people out on the course trying their hand at golf. All day golf for an U18 is only \$5.00. Our Greens' Keeper, Sevi, (*and other club volunteers*) often stop and talk with these junior golfers checking that they have paid and assisting with sand buckets and spare balls. In an effort to make golf more achievable for these juniors the club has provided Green Fees Passes for the RJFNC for weekly award so each of the U15 and U17 football and netball teams. Let's hope we have more of the town's young people out on the park, enjoying themselves, learning the game and seeing just how much work our volunteers put into keeping the course and Romsey Park in its best possible condition



**SUNBURY  
COBAW**

**COMMUNITY  
HEALTH**

**COBAW  
COMMUNITY HEALTH**

**BY TELEPHONE:**  
03 9744 4455

**BY FAX:**  
03 9744 6777

**EMAIL:**  
admin@scchc.org.au

**BY MAIL:**  
PO Box 218,  
Sunbury 3429

**OPENING HOURS:**  
Monday-Friday  
9:00am-5:00pm

## Need Help Connecting with Services?

A free service is available to residents of the Macedon Ranges to help them with accessing government and other services. The service provides the opportunity for people to meet with someone in their home or another place where they feel comfortable, to discuss what support options are available to them to help improve their quality of life.

Sunbury and Cobaw Community Health's Connection Officer Carolyn Colson says that there can be many barriers to getting the help that you are eligible for.

*"Often people are not aware of the funding or the services that are available to them, or they might be unsure how to go about connecting with a service. The barrier might be what they perceive as their lack of computer skills, or they might not feel confident picking up the phone."*

Help might include contacting the National Disability Insurance Scheme, Centrelink or looking at what groups and programs might be available in the local area for people to join.

*"There are so many ways people can enrich their lives, achieve greater independence, learn new skills and connect with others," says Carolyn. "I can help navigate what can be an overwhelming amount of information and together we can find the supports that a person wants and needs."*

The service is open to people under the age of 65, or under 50 if you are Aboriginal or Torres Strait Islander.

To find out if you are eligible for this service, contact Carolyn Colson, Sunbury and Cobaw Community Health's Connection Officer, on 0491 174550 or email [admin@scchc.org.au](mailto:admin@scchc.org.au).

## My council, my vote: Macedon Ranges Shire Council 2024 election

### Content and dates provided by the Victorian Electoral Commission

The Macedon Ranges Shire Council election will be held this October.

The election will be conducted entirely by post – a safe and completely secret method of voting.

We strongly encourage all eligible voters to enrol and vote. Voting is compulsory for all enrolled voters, and you may be fined if you don't vote.

Make sure you've enrolled or checked your enrolment details are correct by the close of roll, which is 4 pm on Wednesday 7 August.

If you are an Australian citizen you can enrol, or update your enrolment, online at [vec.vic.gov.au/enrolment](http://vec.vic.gov.au/enrolment). You can register for VoterAlert at the same time, a free SMS and email reminder service.

If you're not an Australian citizen but pay rates to council, you own or occupy rateable property in Macedon Ranges Shire but do not live in the area, or you are a director or company secretary of a corporation that pays rates to council and have no other voting entitlements for this council, you can apply to become a council-enrolled voter. To find out more and to apply, contact Council on 5422 0333 and apply by 4 pm on Wednesday 7 August.

The VEC conducts elections on behalf of all Victorian councils. For more information, visit [vec.vic.gov.au](http://vec.vic.gov.au).

### Macedon Ranges Shire Council election timeline:

- *Wednesday 7 August: Roll closes at 4 pm*
- *Monday 9 September: Candidate nominations open*
- *Tuesday 17 September: Candidate nominations close at 12 noon*
- *Monday 7 to Thursday 10 October: Mail-out of ballot packs*
- *Friday 25 October: Voting closes at 6 pm*
- *Friday 1 November: Postal vote receipt period closes at 12 noon*
- *Friday 15 November: Latest date all results will be declared.*



# Romsey Mens Shed

*Working on Friendships*



PHOTO caption. Happy members at our Thursday lunch at the Lost Watering Hole!

## ROMSEY MENS SHED - FRIENDSHIPS AND COMMUNITY

### Membership

**Shed membership helps men maintain relationships with other men and at the same time have a broader link to other Romsey and District Community Organisations. We are located in Romsey Park at 47 Barry Street and our operational times are:**

- *On Tuesdays are open from 9-4 for coffee, chats and for those wanting “hands-on” their chosen project work;*
- *Wednesday open around 9:30 for the woodwork enthusiasts and of course coffee and chats:*
- *and Thursday is our most popular day. We open around 9:30 and have a five dollar barbecue/light lunch at 12 and an occasional guest speaker. A brief report of committee activity is also usually given, as well as a five dollar “pub style” meat raffle.*

### Hobbies

Members with more common hobbies can do woodwork, metal work, welding and automotive activities and WH&S is applied. Some basic hands-on skills are also taught from time to time. And some members have other skills in music and less common hobbies and are prepared to work with keen members on skill development.

### Excursions

Our Thursday “Pub Style” meat raffle part funds occasional Thursday lunch outings to the Lost Watering Hole and the 1860 for example, in lieu of the usual self-catered BBQ/light lunches. We also have received some funding to subsidise trips to museums of particular interest and other sites such as the recent trip to Crane Training International at Riddells Creek.

### Proposed Shed extension

As the shed is on Crown Land the Macedon Ranges Shire Council is the initial body to work with and we are currently negotiating to expand the shed lease area to separate the social area from woodwork, to cater for growth and to better prepare us for the future. We only have a small Building Fund, so need a significant financial grant and Shire approval to proceed.

**OUR FACEBOOK PAGE IS:** Romsey Mens Shed Inc. We have a GO FUND ME for the T model project.  
**SHED TIMES:** Tuesdays 9am - 4pm and Thursdays 10 am - 2pm. Open other days by arrangement.  
**MEMBERSHIP APPLICATIONS: SECRETARY:** [romseym@gmail.com](mailto:romseym@gmail.com) or drop in at Barry Street, Romsey

# The Other John Laing



**Everyone seems to know John William Laing, the 90-year-old gentleman, retired farmer, former Romsey Shire Councillor, Life Member of the Romsey Golf Club and loyal supporter of many associations within the Shire, that you could meet down the street in Romsey.**

But it is his uncle, John Albert (*Jack*) Laing, born on 5th July 1884, who is the one featured in this article. Jack was the 9th of 10 children born to James and Elizabeth Laing, who farmed the “*Glendale*” property, (*opposite “Woodlands”*) east of Romsey, that had been purchased by his father William when he moved from Melbourne to Springfield in the 1850’s.

It was the Head Teacher of the small Springfield State School, who encouraged John as a student, describing him to his mother as “*a very intelligent son with lots of promise.*” It was because of this recommendation and her insistence, that her 9th child was sent as a boarder to Scotch College to further his education.

As an athletic student John excelled academically and at sports. He thrived on the competitiveness and team-work required by rowing and football. In 1908 John played football for his team “*University*” in the VFL. Records reveal that he was 6 feet tall and 23 years 339 days old when he played his first VFL match.

He graduated from Melbourne University with a Master of Civil Engineering degree and later specialised in precast reinforced concrete constructions. John married Eleanor Troutback on the 3rd January 1916 at Holy Trinity Church of England, East Melbourne.

At 51 years of age, his ability was recognised by his peers when, in 1935, they elected him as President of the Victorian Chapter of the Institute of Civil Engineers. His consultancy work involved the construction, of the Chapel St./Swan St. Bridge in 1924, the spires of St Paul’s Cathedral, the Burke Rd. bridge in Kew, the design of the old State Theatre (*The Forum*) in Flinders Street Melbourne, which opened in 1929 with the largest seating capacity of any theatre in Australia.

John also consulted on the important constructions of the hotel Alexander, the AMP Building, the Australian Newspaper Mills at Boyer Tasmania, the Associated Pulp and Paper Mills at Burnie Tasmania.

For 10 years John was a specialist lecturer and Council Member of the University, the Faculty of Engineering, the Board of Management and the House and Buildings Committees of Prince Henry’s Hospital. He was also a past Master of the Austral Temple Masonic Lodge and an active chairman of the Community Service Committee of Melbourne Rotary.

It is also of interest that Jack’s youngest brother Robert (*Bob*), father of our John Laing, enlisted in 1915 and served at Gallipoli and in France where, at Bullecourt won the Military Medal and rose to the rank of Lieutenant.

At 60 years of age, John Albert Laing died suddenly at his home in Malvern. He continues to be remembered as a highly respected, talented man who encouraged others and maintained high standards. His life’s story continues to inspire others.

## Soft plastic recycling pilot

**Did you know you can now collect your soft plastic in a special orange collection bag and pop it in your recycling bin?**

Recently, Council launched a shire-wide soft plastic recycling program, allowing residents to recycle their soft plastic conveniently in their kerbside recycling bin.

All soft plastic items that carry the Australasian Recycling Label (*ARL*) – Return to Store symbol or REDcycle logo are accepted in this trial.

If you’d like to participate, visit your nearest customer service centre to collect an information pack, which includes a letter and 20 orange collection bags.

If you don’t want to use the special collection bags or aren’t on Council’s kerbside service, you can take your soft plastic to a Resource Recovery Facility for recycling.

The soft plastic collected in the pilot program will be sent to specialist processors in Victoria to make new plastic products locally, which supports our objectives to reduce waste to landfill, emissions and litter.

For information, visit [mrsc.vic.gov.au/soft-plastics-trial](http://mrsc.vic.gov.au/soft-plastics-trial).

THE ROMSEY RAG

COLLECTORS ITEM - FIRST EDITION

August 15, 1984

EDITORIAL

The ROMSEY RAG is designed to fill a need. To provide the residents of Romsey with current accurate information regarding the many activity groups that are functioning within our community. This first edition has been distributed voluntarily by some of our young people. Further copies are available at the newsagency.

This edition has been made possible because of the sponsorship provided by the Romsey Primary School Council and our thanks are extended to this group.

Closing dates for future editions of the ROMSEY RAG will be the 10th of each month and copy may be left at the Romsey Post Office. This publication is planned to appear before the 17th of each month.

The editorial committee welcome your contributions, suggestions and comments. - Trevor Turnham, Val Lobb, Bev. Large and Beryl Cole.

\*\*\*\*\*

THE ROMSEY UNITING CHURCH YOUTH CLUB:

Formed a little over 12 months ago, the Youth Club is designed to cater for any Grade 6 plus young people. Meetings are usually conducted on the first Sunday of the month at 4.30 p.m. but the next meeting is planned for September 9 when members and friends will make a video tape entitled "ROMSEY NEW FACES".

An Olympic-Australian theme was conducted at the last meeting. Members came in "Australian" fancy dress and participated in a range of ten activities. Winners were awarded Gold, Silver and Bronze medals. Parents and other adults are always invited to the family tea which concludes each activity. A Chinese cooking preparation night was one of the highlights of our program earlier this year.

Contact Susan Shaw (Secretary) on 295 509 or Louise Turnham (President) on 295 413 for further details. You are most welcome.

\*\*\*\*\*

ROMSEY RURAL FIRE BRIGADE

Meetings are held on the 1st Tuesday of the month at Group Headquarters (old Court House) Stawell Street, Romsey.

Radio Schedules, Truck Maintenance and Training every Sunday morning at 8.30 a.m. at the Fire Station. New members welcome.

FIRE CALL ONLY 295 333

For information call Ron Cole 295 411 or Paul Green 295 338

\*\*\*\*\*

DAVID LARGE

needs help to thread an electric whippersnipper. He also has a Honda Scamp for sale, N.V.C.G. suit spares. \$100. Ring 295 558 evenings.

\*\*\*\*\*

More over page

ROMSEY RURAL FIRE BRIGADE LADIES AUXILIARY

The Auxiliary wishes to notify all members and welcome new members, to our next meeting which is on Monday, 3rd September at 8,00 p.m. to be held at Group Headquarters, Stawell Street, Business to be discussed:

1. Catering at Community Market.
2. Catering for Region 14 Demo:--on November 18.

For further information, ring Elenor Moritz 270 411 or Beryl Cole 295 411

\*\*\*\*\*

ROMSEY PRIMARY SCHOOL

Just what is happening at school?? Many people have queried the reasons for large earthmoving equipment operating on the site where the old Presbyterian Manse was removed earlier this year. The School Council are planning for the future in more than one way. Romsey Primary School is planned to be rebuilt on its present site, retaining the original building. The existing very small asphalt area that currently serves over 200 pupils needs to be extended and rather than upgrade and extend the existing paved area, the School Council are developing a concrete paved area north of Palmer Street which will be large enough for two tennis courts and a basketball court. The tennis courts will be enclosed in cyclone mesh and the whole area landscaped into a sports area which will serve the community and school.

THE COMMUNITY MARKET IS ON AGAIN''

It is because the school is concerned that all community groups have the opportunity to get together and grow through a sharing of resources that the 3rd Community Market will be held on Saturday, October 20. Invitations have been extended to stall holders and further queries can be answered by contacting Sandra Strack on 270 472. Please keep this date free and plan to attend, as a family, and support all the associations with which you are involved.

SCHOOL ENROLMENTS 1985

Advanced warning for parents that the Primary School will call for new enrolments during the last week of September. Pupils should turn 5 years of age on or before 30th June 1985. Parents should bring proof of date of birth, i.e. Health Centre Book, Passport of Birth Certificate. Forms for enrolment will be sent home via the kindergarten and are also available from the school. Further information will be advertised in the next ROMSEY RAG.

\*\*\*\*\*

ROMSEY YOUTH CLUB:

Is open to young people from Grade 5 thru Secondary School. We hope to provide a variety of activities and outings, with adults supervising. Any parents who would like to join their children in ANY of our programs would be most welcome. Meetings are held fortnightly at various venues from 7.30 p.m. to 9.30 p.m. Cost is 50 cents per child or \$1.00 per family. A yearly registration of \$2.00 per family is also charged.

\*\*\*\*\*

..still more to come

ROMSEY AND DISTRICT NETBALL ASSOCIATION

Competitions are held on Thursdays from Mid-March to Mid-August (approx.) at the Romsey Stadium.

Juniors 8 to 10 years, Intermediates 11 to 13 years and Seniors 14 to 17 years. Advertisements announcing the start of the Netball season will be placed in local papers.

\*\*\*\*\*

THE ROMSEY UNITING CHURCH

Welcomes the chance to invite readers to share its worship and fellowship. We meet weekly at 9.00 a.m. for Sunday worship and Sunday school.

The Uniting Church Fellowship and Guild meet monthly at 12 noon on the 4th Wednesday. A teenage Youth Group shares a varied program each 1st Sunday of the month. The Young Wives (a fellowship and playgroup) meet fortnightly on Tuesday mornings. There is a Bible Study every Thursday evening at 8.00 p.m. On the 1st Wednesday of every month at 2.00 p.m. we share a service and afternoon tea with the residents of Shamrock Lodge.

Minister - Rev. Adrian Pegler 295 351. Sec. Mrs. Ruth Fan 295 679

\*\*\*\*\*

THE MACEDON RANGES AND DISTRICT MOTOR CLUB

Was formed in December 1983 with the aim of encouraging the restoration, preservation and operation of all types of motorized vehicles and stationary engines. Meetings are held on the first Wednesday of each month at "Dromkeen", Main Road, Riddells Creek, commencing at 8.00 p.m. and are usually followed by a Guest Speaker, films or at the very least, lots of "gasbagging" about old cars and motors. As well as the monthly meeting, an outing is held once a month, giving members and their families a chance to get together and enjoy themselves with their club vehicles.

The range of vehicles being restored by members is quite diverse including a 1911 Excelsior Motor Cycle, 1927 Pierce-Arrow Sedan, 1935 Dodge Roadster Ute, 1938 Buick Hearse, Dennis Fire Engine and many more. Membership is open to any interested person. Fees are \$10 per year for family membership, or \$5 per year for junior membership (up to 18 years). Limited registration is available for vehicles 25 years and older. Further information can be obtained by phoning either George Porter, (Pres.) 286 336 or Graeme Lemin (Sec.) on 295 725 or by writing to P.O. Box 210, Riddells Creek.

\*\*\*\*\*

THE ROMSEY SPORTS AND RECREATION CENTRE

is made up of the Tennis and Squash Clubs and a public stadium which houses a tennis court, netball and basketball courts, badminton and volleyball courts.

There is a very active badminton club and a junior and senior netball competition. The whole centre is run by a management committee. Currently there is very little interest in this committee and we would LOVE some keen people to come and help. Our Annual General Meeting is August 30 at 7.30p.m. at the Centre. Any queries please contact Lee Howells 295 378.

\*\*\*\*\*

still more ...

ST. PAUL'S CHURCH OF ENGLAND KINDERGARTEN, ROMSEY

has one kindergarten teacher, Mrs. Helen Else, and one assistant, Mrs. Lyn Cornish. Currently 46 pre-school children attend, four sessions per week. A playgroup for 3 year olds is run Tuesday afternoons in the kinder building under the guidance of their mothers.

The kindergarten endeavours to provide friendship, stimulation, social contact, skill development, added awareness and confidence for the children who attend in preparation for them to be ready for school the following year. Bookings may be made at any time through Mrs. Else at the kindergarten, 295 294. Currently we are constructing a tricycle track around the perimeter of the playground and hope to have it completed by third term.

\*\*\*\*\*

ROMSEY AND DISTRICT HISTORICAL SOCIETY

Meetings of the Society are held on the 4th Tuesday of each month, February thru December at 8.00 p.m. when interesting speakers and activities are organised. The next meeting, Tuesday 28th August is at the Romsey Mechanics Hall Meeting Room, and new members are very welcome. Two interesting projects presently being undertaken are the restoration of Sidney Seymour Cottage in Palmer Street, Romsey and the establishment of a local museum at Lancefield Court House to be officially opened by the Attorney-General on Sunday 25th November at 2.00 p.m.

Membership \$3.00 annually. Contact Secretary Mrs. Helen Clement for further information on 295 317.

\*\*\*\*\*

ROMSEY RED CROSS UNIT:

Meetings held in the Meeting Room of Romsey Mechanics Hall on the 2nd Wednesday of alternate months at 10.00 a.m. when fund raising and welfare activities are planned. Members assist with the Annual Red Cross March Appeal, the delivery of Meals on Wheels, organise First Aid courses, help at Greevale Geriatric Centre, do hospital and home visiting to the ill and elderly and help with transport to medical centres. Catering and first aid teams are ready to assist in times of emergency in the community. New members always welcome. Contact Secretary, Mrs. Shirley Shelton 295 217 for further details.

\*\*\*\*\*

ROMSEY SHIRE COUNCIL

Have received funding for the employment of a part time social worker. Funding for this position has been made available as one of the community service projects being established to celebrate Victoria's 150th Anniversary.

Lindy Neve will be based at the Shire Office, Monday, Tuesday, and Wednesday mornings and can be contacted on 295 201.

So, if for example, you are having problems with your marriage or a personality clash with one of your children or want to know more about some health or welfare service and where they are, please contact Lindy. If she is not able to help she can put you on to someone who can. The position is funded until November 1985. Before that time it is hoped to see what social and welfare needs can be serviced within the community.

\*\*\*\*\*

and more yet...

ROMSEY RAG. PAGE 5

ROMSEY COMMUNITY LEISURE GROUP

Members of this newly formed group of ladies are enjoying their time together very much. We meet on Thursday mornings from 9.30 a.m to 12.30 p.m. in the Uniting Church Sunday School which has every facility for comfort and work. We average 17 members a session.

Crafts being carried out include, knitting, crocheting, tapestry, sewing, spinning, weaving and toy making. Our aims for the future will include demonstrations and other crafts. A recent bus trip to the Annual Sheepbreeders Woolcraft Show to see the crafts was very worthwhile.

New members of any age, both male and female, are very welcome to join us. Admission 50 cents a session.

A chocolate making demonstration will be held on September 6 in the Scout Hall at 9.30 a.m. Admission \$1.00 For further information ring P. Mitchell 295 221 or P. Lobb 295 415.

\*\*\*\*\*

FINIS.

TT,VL

## THE ROMSEY RAG, A HISTORY

In the early 1980's a photocopier was a rare luxury in primary schools and so Romsey local school news was conveyed in the weekly duplicated newsletter or in the only local paper based in Sunbury. Local contributions to that paper were often not printed at all or the heavily edited. There was clearly a need for a local newspaper.

Inspired by the "Wallan Whistle", a free community publication, it was decided that Mrs Barbara Rowlands, (a committee member of that group), should be invited to explain the operations to Trevor Turnham (Principal of Romsey Primary School) who together with Mrs Beryl Cole, Mrs Bev Large and Mrs Val Lobb formed the initial editorial/publishing committee undertaking responsibility for a duplicated news sheet which would become known, (following a suggestion from Mrs Lobb), as "The Romsey Rag". - Three sheets of A4 white paper printed on both sides. A very humble beginning for the now very widely distributed, important community newsletter that has been nurtured by successive groups of dedicated volunteers, who have ensured that the professional edition we now hold in our hands reflects our community.

A \$500 grant was made available for this purpose through the Education Department's "School Improvement Program" and so on the 15<sup>th</sup> of August 1994, using the black ink and Wax stencils on a Gestetner duplicator, the first Romsey Rag (marked "collector's copy") was published.

The first Romsey Rags were collated on Beryl Cole's kitchen table to be later delivered to letterboxes by members of the Uniting Church Youth Group.

The committee felt that the Romsey Rag should feature not only school news but also the activities of all groups in Romsey District. Articles solicited from local activity groups would be dropped off at Romsey Post office from where Beryl Cole would take them for typing.

Over the years many people have been involved in the typing, duplicating, collation and distribution of this ongoing, voluntarily produced community resource. In 1989 Mrs Margaret Howatson not only assisted with typing but also became involved with its sponsorship and advertising.

After Trevor Turnham retired in 1999, new principals included Barney Healy, Joan Gibbs provided encouragement and support as proof-readers and contributors. Once computers and word processing were introduced to the school, production became much simpler.

From 2015 the Primary school found itself unable to dedicate sufficient resources to the production of The Rag and in 2018 production was taken up by a separate community committee and their dramatically fresh approach resulted in the easily read, professionally presented publication that we now see both in print and on-line.



## Road Closure

Finally, after many many years of trying we have secured the road closure of Raglan Street so that students can safely move around the school grounds without road safety concerns. During the term break fencing went up to secure the area. Raglan Street between Dunsford Street and Chauncey Street is now a NO THROUGH ROAD. There is no pedestrian access during school hours, but the gates will be open for access at the end of the school day. This is a momentous occasion for St Mary's and we must thank Julie McDougall our former principal for all her hard work in making this happen, along with Mick McCarthy (*School Advisory Board Chairperson*) for his assistance and expertise. We would also like to acknowledge the generosity of Terraco - Civil Engineers, Project Managers, Development Consultants (<https://www.terrace.com.au/>) who donated their services in the design of the road closure works. We thank them for their kind donation. It's an exciting time as we now look at how we can make this a wonderful space for our students.

## Favourite Beanie Day - Fight MND Fundraiser

On Friday 14th June we held a special fundraising event to help raise funds for Fight MND. Last year we were lucky enough to have Daniher's Drive visit St Mary's, which was such an amazing event for our school and at that time we pledged to continue the annual fundraising for this very important cause. This year we asked our students to wear their favourite beanie to school and bring in a gold coin donation. Mrs Kennedy fired up the 5/6 's by confirming that if they were able to raise \$50 in gold coins, she would take the ice bucket challenge! Well of course this fired everyone up! The Sports Captains came to see me and wanted to run another ice bucket relay like last year. So it was a quick run around on Thursday afternoon, confirming staff members to brave the ice bucket.

Of course everyone was in, so Team 1 consisted of our Sports Captains, Mason, Cohen, Edie, Millie, Harper G, Charlotte Mc, Pippa and Meg. Team 2 consisted of our great leader Mrs Agius, plus Mrs Giles, Mrs Awty, Miss Fisher and of course Mrs Kennedy. Our school leaders made up the 8, so we thank Emmett, Sophie and Ruby for also joining in.

We made sure each bucket was filled halfway with ice, then water (*we had to be sure it was nice and cold!*) and once we figured out how the relay worked (*we got there eventually!*) we were set to go.

Hilarity prevailed as each person was dually dumped with ice cold water, some even left the buckets on their teammates head. Lots of cheering and screaming from the rowdy crowd as the Sports Captains easily won the relay. A great event once again. We'd like to thank everyone who took part and of course everyone in our amazing community for their generous donations. A huge thank you to Liberty Service Station in Lancefield for donating the ice, a very generous donation that was greatly appreciated! We made a total of \$436.50 (*\$205 raised by the 5/6 's alone!*) which we then donated to Mrs Stevens MND fundraiser as she prepared to take the Big Freeze Slide as part of the RJFNC Big Freeze fundraiser on Sunday 16th June.

Congratulations to Mrs Stevens who not only took the plunge into very icy cold depths, but at last count raised over \$2500 for Fight MND. A magnificent effort.



## Student Showcase of Learning

Term Two concluded with a 'Student Showcase of Learning'. Students from Prep - Six showcased the great work they produced during their Inquiry Learning throughout the term. The themes were;

Prep - 'How it Works' Students explored how the toys they play with work. They investigated ways objects move depending on size, shape and how forces (*push or pull*) influence how they are used.

Year 1/2 - 'Sharing the Planet' By learning about different places around the world students developed an understanding and appreciation of diverse locations and ways of life.

Year 3/4 - 'Sharing the Planet' Students developed a deepening awareness and appreciation of diverse environments and the interrelationship between living things. They learnt how humans can impact and utilise the Earth and its resources in responsible and sustainable ways.





Year 5/6 - 'How Animals have adapted to their Environment' Students developed an awareness of the cause and effect relationship between humans (*and their impact*) and the environment and the factors contributing to animal adaptations.

We had a huge turnout of family members join us to see all the wonderful learning and creative work on display by our very talented students. It was wonderful to see their enthusiasm and share in their learning experience. A massive congratulations to all of our students for their impressive displays, keep up the great work.



COME & JOIN US - IT'S FREE  
EVERYONE IN OUR LOCAL & WIDER  
COMMUNITY IS WELCOME!





Mondays & Fridays  
8.30am - 10am  
during school terms

Term 3  
Monday 22nd July - Monday 16th September  
Friday 26th July - Friday 13th September

Contact us -  
Ph 5429 1359  
Email [playgroup@smlancefieldcatholic.edu.au](mailto:playgroup@smlancefieldcatholic.edu.au)  
Address 2 Raqlan St Lancefield (held in the school hall)





## Playgroup @ St Mary's

We'd like to invite everyone within our local and wider community with little ones aged from 0-5 years to join us for Playgroup @ St Mary's. This term we will be running Playgroup every Monday and Friday morning. It's FREE and a great way to meet other families in the area and enjoy some play time with your children. We're very welcoming - so why not come along and give it a go!

**Jo Shannon** (Community Liaison Leader)

## Spring mulch promotions

With Spring just around the corner, get started on your garden now with free self-loaded mulch available at Council's three Resource Recovery Facilities at Kyneton, Romsey and Woodend.

Or if you need a bit more, Council staff can load mulch for you at a reduced cost of \$15 per cubic metre (*previously \$30*).

Thinking about doing a backyard clean up? Keep an eye out for green waste trailer vouchers included in the next edition of ShireLife.

## Budget 2024-25 road works

In the 2024-25 financial year, Council is again strategically prioritising a number of local road and infrastructure upgrades across the shire as part of the Budget 2024-25.

In the Romsey area, these projects include:

- Main Road, Romsey – east side pedestrian bridge refurbishment

These upgrades will be progressed alongside other locations prioritised through recurring annual maintenance programs such as bitumen resurfacing, gravel road renewal, road stabilisation and guardrail upgrades.

## Council's dog off-leash and prohibited areas – share your thoughts

**Did you know, Council has 52 designated dog off-leash areas and a number of prohibited areas (for dogs and cats) across the shire?**

Council is currently seeking your feedback on how these areas are working. Suggestions for improvement of existing areas are welcomed, as are suggestions for new areas to be considered.

Whether you are a pet owner or not – everyone's voice is important.

Feedback gathered will assist Council in preparing potential activities for inclusion in the next Domestic Animal Management Plan (2025 – 2029), including any adjustments to the dog off-leash and prohibited areas (*also known as Council's Dog and Cat Order 2019*).

Find out more and share your thoughts until 11 August 2024 by visiting [yoursay.mrsc.vic.gov.au/dog-areas](https://yoursay.mrsc.vic.gov.au/dog-areas).



## Romsey - Lancefield Probus - Welcome to friendship

### Having Fun, Making New Friends, and Catching-up with Old Ones!

The Romsey/Lancefield Probus Club is for active retirees or semi-retired people to meet, relax and enjoy the welcoming company of those at the same stage of life. There is a regular monthly meeting with guest speakers, morning tea and time to socialise with the other members. Each month there is a regular outing for lunch held at different venues around the region as well as short and longer trips throughout the year. There is a coffee morning at 10 am every Friday at the Lancefield Corner Store where members meet for a chat and a bit of fun.

In July Allison Burns, the founder of Bella's Footprint Foundation- Button Battery Awareness was our speaker. Since last announcing her as our speaker Allison has been awarded an OAM (*Order of Australia Medal*) in recognition of her life saving work

Our winter warm-up boxed lunch at the Lancefield Annex was very successful with a three course meal of soup, sandwiches and cakes. After lunch we were entertained by Helen Keanan and Tash Luke both local singers and performers from the area. The members thoroughly enjoyed the musical performance by both singers.

Due to lack of numbers our trips have been postponed until next year hopefully giving more time to encourage greater numbers.

#### Contact:

President: **Noreen 0401 579 180**

Secretary: **Betty 0409 359 048**

Visit our website: [www.rlprobus.org.au](http://www.rlprobus.org.au)

*We are a friendly, welcoming group from diverse backgrounds with a variety of interests and we'd love to meet you! Feel free to attend a meeting as a visitor.*

## ***Romsey Primary School July 2024***

### **VIS ATHLETE VISIT**

On Friday 14<sup>th</sup> of June, we had a visit from Reece Langdon who is a VIS (Victorian Institute of Sport) scholarship athlete. His event is the 1500m, and he is a para-athlete.

In December 2002 (age 6) Reece started getting severe headaches, so his parents took him to hospital. He soon lost his ability to talk and walk and became almost completely paralysed. They discovered he had severe streptococcal which led to a virus, which attacked his cerebellum. Reece was diagnosed with Cerebellitis. He gradually relearnt how to walk and talk, but was left with permanent ataxia, coordination impairment, temperature regulation issues, and general weakness on the left side of his body.

Reece spoke about his training, nutrition and also motivated students that if you want to succeed at something you must put in the hard work. He spoke very well and was very engaging for all those participating in the presentation.

He is a silver medallist at the 2023 World Championships and he will compete at the Paris Paralympics in September this year.

Reece is a true inspiration to all, and we wish him all the best when he competes for Australia.



# BIG FREEZE 10

## A FIGHT MND EVENT

On Sunday 16<sup>th</sup> June, on what was definitely one of the coldest days EVER in Romsey, our amazing Wellbeing Coordinator 'Princess' Leanne Stewart participated in the BIG FREEZE event at Romsey Junior Football and Netball club. She plunged into the ice pool to support raising money for MND research. Dressed in her princess frock she gave the royal wave as she slid down the slide cheered on by many students and parents from our school community.

Well done Mrs Stewart !!!!!!!





# PREP INFORMATION SESSIONS AND SCHOOL TOUR DATES FOR 2025 ENROLMENTS



## INFORMATION SESSIONS FOR FAMILIES & PREP CLASSROOM TOUR

Date : Thursday 1st August

Time: 10 am

Venue: Meet at the office then will head to the Prep rooms for an information session with the Prep teachers and school leaders.

**REGISTER NOW**

Please register your interest for any session by emailing the school on [Romsey.ps@education.vic.gov.au](mailto:Romsey.ps@education.vic.gov.au) or phoning 5429 5099  
Bookings are essential for all sessions





**ENCOURAGE CHURCH  
ROMSEY**

**WORSHIP SERVICE:**  
Sundays @ 10am

**SENIOR PASTOR:**  
Pastor Tim Emonson

**OFFICE:** 7 Mitchell Court, Romsey  
P: (03) 5429 6327

**EMAIL:**  
office@encouragechurch.com.au

**WEBSITE:**  
www.encouragechurch.com.au

- Mainly Music
- Children's Church
- Before & After School Care
- Youth Activities



**FROM THE DESK OF PASTOR TIM**

**RUNNING THE RACE**

The Paris Olympics have been on and many of us have watched athletes from around the world competing to win a medal (*preferably gold!*). The athletes have trained for many years, being disciplined in their training, what they eat and what they do. All for the glory of being the best in the world.



In the bible, in Paul's first letter to the Corinthians, he spoke about living our lives like those athletes. Being disciplined and running in a way to win. Unlike the Olympics where only first place receives the gold medal, Paul was talking about life where all can receive an eternal prize.

So how are you running the race of life? Just in a way that only you win, but the prize you get will fade away? Or are you storing up treasures in heaven, which will last for ever?

Don't you realize that in a race everyone runs, but only one person gets the prize? So run to win! All athletes are disciplined in their training. They do it to win a prize that will fade away, but we do it for an eternal prize. So I run with purpose in every step. I am not just shadowboxing. I discipline my body like an athlete, training it to do what it should. Otherwise, I fear that after preaching to others I myself might be disqualified. 1 Corinthians 9:24-27 (NLT)

If you want to learn more about running the race of life, join us for one of our services at 10am each Sunday at 7 Mitchell Court in Romsey.

Come along to one of our Sunday morning services at 10am and check out our seats - everyone is welcome!  
If you would like to know more about Encourage Church, come along to one of our activities! You can also check us out on our website [www.encouragechurch.com.au](http://www.encouragechurch.com.au) or email us at [office@encouragechurch.com.au](mailto:office@encouragechurch.com.au).

**Your Local Camera Club**  
in the Macedon Ranges Region



**Macedon Ranges  
Photographic Society**

If you love photography,  
and would like to join in on the fun,  
whether you are a complete novice or  
a fully fledged professional,  
we would love to hear from you.  
Interested in Membership?  
Go to the membership page for all the details  
<https://macedon-ranges-photography.org.au/about/>



**CLUB NIGHTS**  
Generally the first Tuesday of the month  
(General meeting and competition nights)  
The following Monday night  
(Technical nights: tutorials and practicals).  
7.00pm for a 7.30pm start  
at Dromkeen, 1012 Kilmore Rd, Riddells Creek VIC 3431  
eMail: [info@macedon-ranges-photography.org.au](mailto:info@macedon-ranges-photography.org.au)  
Web Site: [macedon-ranges-photography.org.au](http://macedon-ranges-photography.org.au)

**BOLINDA  
PRIMARY SCHOOL**



[www.bolindaps.vic.edu.au](http://www.bolindaps.vic.edu.au)  
Small Class Sizes  
Synthetic Phonics Approach  
Inclusive School Culture  
Student Leadership Development  
Innovative STEM Program  
Whole School Kitchen Garden Program  
Before & After School Care  
Contact us now for a tour  
**(03) 5428 5317**

# ANGLICAN CHURCH OF CHRIST CHURCH LANCEFIELD WITH ST PAUL'S CHURCH ROMSEY

## AUGUST CHURCH TIMES ARE TEMPORARILY ALTERED

- Aug 4th Combined Church Service Christ Church Lancefield
- *Aug 11 Romsey Sunday Service* - 9:00am / Lancefield Church Service - 10:30am
- *Aug 18 Combined Sunday Service* - 10:30am
- *Aug 25 Romsey Sunday Service* - 9:00am / Lancefield Sunday Service - 10:30am

**PRAYER MEETING:** Church Hall Lancefield Thursday 9:30am

**BIBLE STUDY:** Christ Church Lancefield Hall Thursday 10:30am  
Come and enjoy a cuppa while spending time pondering the Bible.

## MONTHLY PARISH COMMUNITY LUNCH:

Next Lunch will be on Saturday, 10th Aug 12:00 noon at Christ Church Hall Lancefield .  
The day is free. Everyone is welcome to join us - good homemade food & a great time to meet new people & chat with old friends and time to make new acquaintances.

## ST PAUL'S OPSHOP:

- *St Paul's OpShop Open Times:* - Friday 12:30-4:00 & Saturday 10:00-1:00pm.

View the Op Shop on the Parish Web site to see the week's specials. Leave your valued donations of clothing, Bric & Brac, craft items, books & good quality working toys on Friday afternoon and Saturday Morning. These are much appreciated. Sadly donations left outside were either wet or damage owing to the weather consequently were sent to the tip. Due to regulations we cannot accept electrical goods, prams, baby cots, furniture or mattresses. Your ongoing support and donations is much valued and appreciated.

**The St Paul's Church Hydrangea's are pruned and cuttings are available for purchase at \$1.00 a bunch of 10 cuttings.**



ANGLICAN PARISH OF  
**LANCEFIELD**  
WITH  
**ROMSEY**

**THE ANGLICAN PARISH OF  
CHRIST CHURCH LANCEFIELD  
WITH ST. PAUL'S ROMSEY**

**Vicar**  
Rev Matthew Browne  
**P:** 0401 615 099



May God watch over us all and keep us safe during this testing time as we put our faith and trust in Him.

**Romsey Dental**  
FAMILY DENTAL CARE

Advance Technology  
Quality Doctors

- General & Cosmetic
- Laser Treatments
- Same day Crowns & Veneers
- Happy Gas & Sedation
- Bridge Work
- Implants
- Same day Emergency Appointments
- Dental Radiography
- Children's Dentistry
- Clear Aligners (Invisalign)
- Teeth Whitening
- Dentures

zip DentiCare  
PAYMENT SOLUTIONS

41 MURPHY ST ROMSEY | ROMSEYDENTAL.COM.AU

**03 5429 3322**

**BETTER LIVING**  
**OSTEO**

- Back and neck pain
- Headaches
- TMJ Dysfunction
- Sports injuries
- Tendonitis and bursitis
- Joint sprains

Call us on (03) 4311 1876 to find out if Osteopathy is right for you.

Open Monday - Saturday.  
Evening appointments available.

28 Wrixon Street Romsey  
www.betterlivingosteo.com.au

/betterlivingosteo



**THE UNITING CHURCH IN AUSTRALIA MACEDON RANGES PARTNERSHIP**

**Romsey Congregation**  
25 Pohlman Street,  
Romsey 3434 (P.O. Box 264)

**Worship Services**  
**SUNDAY, 9:30am.**

**Chairperson**  
Mr. Noel Shaw  
P: 5429 5509

**Secretary**  
Mrs. Jenifer Clampit  
P: 5429 5480

Let the peace of Christ rule  
in your hearts and homes.  
Let the word of Christ  
dwell in you richly.  
God comes to us,  
each and every one.  
God bless you every day.

**ROMSEY UNITING CHURCH**

MINISTER: Pastor Annette Buckley. Ph. 5429 5351 / 0457 608 539  
WEBSITE: [www.macedonrangesunitingchurch.org.au/worship-services](http://www.macedonrangesunitingchurch.org.au/worship-services)

**GOD OF HOPE. BY REV. JON HUMPHRIES (UCAF NETWORK MAY 2015)**

Christ with us. In our darkness you see the spark of your light. In our struggles, you wrestle with us.

In our pain and suffering, you hurt with us. In our weakness you lend us your strength.

In our ignorance, you try to teach us wisdom. In our selfishness, you lead us to your way of the cross.

In the breaking down of our relationships you pave the way towards reconciliation.

In our falling short of your glory, you lift our eyes to see our potential.

Into our desperation you bring hope. Into our brokenness you bring healing.

Into our failure you bring redemption. Into our living you bring meaning and purpose.

Into our dying you bring life. God of Hope, Christ with us, In your image we are created. In you we are made complete. In your way we seek to follow.

In your truth we are revealed. In you we find life.

God of Hope, redeem and transform us, That we may truly be your people.

This we ask. Amen.

**PRAYER IS SO SIMPLE**

It is like quietly opening a door and slipping into the very presence of God. There in the stillness to listen to God's voice. Perhaps to petition or only to listen. It matters not. Just to be there in God's presence is prayer.

**GENTLE EXERCISE CLASSES**

At St Marys Church Hall, Romsey  
**Mondays at 10.30am**  
**Wednesdays at 10am**

**\$8 PER CLASS**

Call Justine on 0412 999 822

email [outsidetheboxt@gmail.com](mailto:outsidetheboxt@gmail.com)

A Fun, Friendly and Gentle approach to exercise to exercise for all levels of fitness.

Build and maintain your strength and joint health.

Optional use of light weights, a strength band or a small ball.

All equipment supplied, standing and chair based exercises



**As your local Member of Parliament, I'm here to represent you and our community.**

**I'm keen to hear about the issues that matter to you.**

**Mary-Anne Thomas MP**  
**Member for Macedon**

☎ 5428 2138

🌐 [mary-annethomas.com.au](http://mary-annethomas.com.au)



Authorised by MA Thomas, Shop 14, Nexus Centre, 9 Goodie Street, Gisborne



## ST. MARY'S PARISH LANCEFIELD & ROMSEY

### CURRENT MASS TIMES:

#### Sunday Mass

Sunday Mass will be celebrated at 9am and will alternate between Lancefield & Romsey. 1st & 3rd Sunday's of the month in Romsey, 2nd, 4th & 5th Sunday's of the month in Lancefield.

#### Saturday Healing Mass

The Healing Mass will be celebrated at 10am in Romsey on the 1st Saturday of each month.

#### Baptisms

Baptism's are held on the 4th Sunday of the month. Please contact the office for the next available dates.

#### Sacraments - 2024

Bookings are still open for parish children to register for the Sacrament of Confirmation in 2024.

Please contact the office if you would like to register your child.

Should a parishioner want to go to Reconciliation, please contact Fr. Martin directly at Woodend on 5427 2690 or Fr. Brian directly at Lancefield on 5429 2130 to make arrangement.

Please direct enquiries to the parish office on 5429 2130 or by email at lancefield@cam.org.au

FOR FUNERAL ARRANGEMENTS, PLEASE CONTACT: Fr. Martin on 5427 2690 or by email at woodend@cam.org.au or r. Brian on 5429 2130 or by email at lancefield@cam.org.au



#### ST. MARY'S PARISH - LANCEFIELD & ROMSEY

27-29 Chauncey Street Lancefield & 85 Main Road Romsey

#### PRESBYTERY OFFICE HOURS:

Wed & Fri 8am - 5pm

E: lancefield@cam.org.au

P: 5429 2130

#### Parish Priest

Fr. John Healy

C/- Woodend Presbytery

P: 5427 2690

#### Assistant Priest

Fr. Brian Muling

C/- Lancefield Presbytery

P: 5429 2130

#### SCHOOL WEBSITE:

www.smlancefield.catholic.edu.au

1800 011 141  
www.greensweep.com.au

## Green Sweep

Caring for you and the environment

**Your local home cleaning specialists**  
How good would it feel to come home to a fresh clean house all of the time? Well now you can get that feeling whenever you want it.

Let us take care of all your cleaning needs allowing you to spend your precious spare time doing more important things.

<b>Services offered</b> <ul style="list-style-type: none"><li>● Regular weekly or fortnightly cleans</li><li>● Spring cleans</li><li>● Exit / bond cleans</li><li>● Window cleaning</li><li>● Commercial cleaning</li></ul>	<b>Products used</b> <p>We only use eco-friendly products inside your home, allowing you and your family to breathe easier, while reducing the impact on the environment.</p>
---	---

**Security and privacy**  
Your privacy and security is important to us, we are fully insured and security screened for your peace of mind, our services are discreet, efficient and affordable.

**Ask us how we can help you today**  
For an obligation free quote call us on 1800 011 141 or visit our website [www.greensweep.com.au](http://www.greensweep.com.au).

We're proud to be **Eco Friendly**

Refer a regular client and receive one free regular clean\*

\*Conditions apply

Find us on Facebook:  
[Facebook.com/Greensweepteam](https://www.facebook.com/Greensweepteam)

# RANGES

## PODIATRY

Local - Thorough - Friendly

✓ Diabetes care	✓ Foot Orthotics
✓ Heel pain	✓ Children's feet
✓ Tricky foot problems	✓ Sports injuries

---

**Andrew Baddeley**  
B.Pod, GradCert.DiabEd

---

**Located within Romsey Medical Centre**

**Phone: 03 5429 5254**

**[www.rangespodiatry.com.au](http://www.rangespodiatry.com.au)**

# Business & Trade

## DIRECTORY

### ACCOUNTS & BOOKKEEPING

#### KRAMMER ACCOUNTANTS

Email: [wkrammer@bigpond.net.au](mailto:wkrammer@bigpond.net.au)

W.F (Bill) KRAMMER FPNA

**ESSENDON:**

Surte7, 2<sup>nd</sup> floor,  
902 Mt Alexander Road, Essendon

Tel: (03) 9326 0211

**ROMSEY:**

106 Main Street,  
Romsey 3434

Tel: (03) 5429 5477

### AUTO

## WE BUY

**CAR - CARAVAN - MOTORHOME**  
**0418 183 360**

Cash - Bank Cheque - Finance Paid Out - EFT

## SELL TODAY

LMCT 10132 SHD 0015048

### ACCOUNTS & BOOKKEEPING

#### FINELINE BOOKKEEPING

*by Adriana*

- ✓ General Bookkeeping
- ✓ Payroll management & compliance
- ✓ BAS preparation & lodgements
- ✓ Setup & training of accounting software
- ✓ 20+ years experience



M 0404 442 443

E [adriana@fineline-bookkeeping.com.au](mailto:adriana@fineline-bookkeeping.com.au)

### BLINDS & AWNINGS

## SHERIDAN

BLINDS & AWNINGS

DAVID AND LEE SHERIDAN

David: 0419 034 941

[info@sheridanblinds.com.au](mailto:info@sheridanblinds.com.au)

Lee: 0417 526 844

[sheridanblinds.com.au](http://sheridanblinds.com.au)

### CABINETS

**Romsey Cabinets  
& Installations**  
Incorporating Panache Joinery

## GREG WILSON

Repairs, Alterations, Robes & Kitchens

0484 637 605

### ELECTRICAL

## BEYOND ELECTRICAL

DATA & SOLAR

YOUR LOCAL "A" GRADE ELECTRICIAN  
SERVICING THE MACEDON RANGES FOR  
OVER 25 YEARS

## 0419 399 590

PROVIDING SOLUTIONS FOR ALL DOMESTIC,  
INDUSTRIAL & COMMERCIAL NEEDS.  
NO JOB IS TOO BIG OR TOO SMALL.

⚡ RELIABLE 24 HOUR SERVICE

⚡ POLICE CHECKED

⚡ NO OBLIGATION FREE QUOTES

[INFO@BEYONDELECTRICAL.NET](mailto:INFO@BEYONDELECTRICAL.NET)

#### CJ BROMLEY ELECTRICAL P/L

For All Your Electrical Requirements  
Switch Board Upgrades, Extensions  
Sheds, Garages, Smoke Detectors  
LED Lighting, Ceiling Fans, Oven  
Repairs, Split System Air Cons  
TV, Phone & Data Cabling

**SOLAR**

Cleaning, Testing & Maintenance

Servicing Romsey & Surrounds for 23 Years

**M: 0419 580 380 Ph: 5429 5938**



REC 13897

[colinjbromley@gmail.com](mailto:colinjbromley@gmail.com)

REC: 26561  
**NECA MEMBER**

national electrical and communications association



### FIREWOOD

## LANCEFIELD FIREWOOD

# SPLIT RED GUM FIREWOOD

**\*LPG 45kg Cylinders  
Rental Free\***

**PH MANNY 0418-570-249**

### YARD SALES

Ph: **Amanda 0438-570-249**

Email: [sales@lancefieldfirewood.com.au](mailto:sales@lancefieldfirewood.com.au)

547 Lancefield-Tooborac Road, Lancefield

Visit us at [lancefieldfirewood.com.au](http://lancefieldfirewood.com.au)



CREDIT  
CARDS  
ACCEPTED

### FENCING



Slotted Post and Rail  
Post & Rail  
Post & Wire netting/mesh  
Horse Fencing & Dog Yards  
Chicken Coops  
Paling & Picket Fencing  
Electric & Farm Fencing  
Fencing Repairs & Maintenance  
Call Rob on **0437 958 345**

### MAINTENANCE

## NORTH WEST HOSE & FITTINGS



ABN 98 452 942 518

**Paul Fabris**

M 0411 554 368

E [nwhandf@iprimus.com.au](mailto:nwhandf@iprimus.com.au)

A 1792 Romsey Road, Romsey, Vic 3434

**Best under pressure**



**Hydraulink**  
Hose and Fittings

### PLUMBING



- Hot Water Units
- Gas Fitting
- Split Systems
- Hydronic Heating
- Rain Water Systems
- Bathroom & Kitchen Renovations
- Roofing & Drainage

Servicing Macedon Ranges  
No job too small

**Paul Murphy 0438 298 659**



[murphysplumbingvic@gmail.com](mailto:murphysplumbingvic@gmail.com)

### PLUMBING

## DEMAK PLUMBING

- \*Hot Water Service Installs
- \*Sewer Camera & Jet Machine
- \*Drainage Works
- \*All Plumbing Maintenance

**0448 584 924**

Servicing Macedon Ranges  



### VETERINARY SERVICES

## ROMSEY VETERINARY SURGERY

 **5429 5711**

[romseyvet@apiam.com.au](mailto:romseyvet@apiam.com.au)  [romseyvet.com.au](http://romseyvet.com.au)  
80 Main Street Romsey VIC 3434



# Business & Trade

## DIRECTORY

### HOME & GARDEN

## PH Roofing

Trevor Harbinson

Mobile: 0411 508 120

Phone: 5429 6632



- Storm Damage
- Re-bedding and Pointing
- Repairs
- Free Quotes
- Extensions

### HOME & GARDEN

## Quick Fix Services

- Small Repairs & Construction
- Labour Hire
- Light Fabrication
- Home Maintenance

Fully Insured  
ABN: 74 565 332 611



**Colin Showler**

Mob **0419 322 921**

Email **c.showler@inbox.com**

6 Gwen Place, Lancefield 3435

### HOME & GARDEN

## CENTRAL TREE CARE

Professional Tree Service  
**BRADLEY NUTTALL**  
Adv. Cert. of Arboriculture

Travel Tower 18 Palmer Street  
Wood Chipper Romsey, 3434  
Tree Climbing Phone/Fax: (03) 5429 5549  
Stump Removal Mobile: 0409 023 282



## YOUR AD HERE

For advertising enquiries to;  
[email@theromseyrag.com.au](mailto:email@theromseyrag.com.au)

**Romsey Rag**

## THE MOUNT PLAYERS

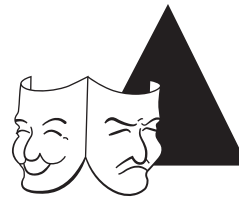

The Mount Players

### The Players 3rd Production by Award Winning Australian Playwright, David Williamson.

Family Values is written by David Williamson, a celebrated, Australian playwright with a plethora of iconic plays to his name including Dons Party, The Removalists, After The Ball, Money & Friends to name a few. He also collaborated on the screenplays for the films Gallipoli and The Year of Living Dangerously.

This contemporary Australian play is filled with razor sharp humour that both entertains and challenges its audiences.

Directed by Woodend local, David Runnalls, Family Values introduces us to the Collins family as they gather to celebrate their father Roger's 70<sup>th</sup> birthday.

The retired Supreme Court Justice and his wife Sue have their plans for a quiet family gathering blown apart after unwittingly bringing together a detention centre escapee, a border force commander and three siblings all on the verge of unleashing a lifetime of simmering resentments.

Humorous, thought provoking and at times deeply moving, Family Values will have audiences laughing while prompting them to consider their own beliefs and values.

The season runs from 16 August – 1 September. To book tickets go to [www.themountplayers.com](http://www.themountplayers.com) or call 5426 1892 for assistance.

See you at the theatre!

By Karen Hunt & Mel Forge



KATE Mooney, Melissa Forge, Peter Bevin, Ingrid Gang, rear is Elissa Stephens

## HOME FIRE SAFETY CHECKLIST

- Smoke alarms**
- Test and clean regularly.
  - At least one on each level.
  - One in every bedroom.
  - Replace all smoke alarms after 10 years.

- Heaters**
- Install, maintain and operate according to manufacturer's instructions.
  - Keep 1 metre clear space around.
  - Turn off before going to bed or going out.

- Chimneys and flues**
- Clean yearly.

- Candles**
- Keep away from curtains.
  - Always use on non-combustible surfaces.

- Bedroom**
- Never smoke in bed.
  - Don't leave laptops on bed

- Kitchen**
- Never leave cooking unattended.
  - Keep combustibles such as tea towels and curtains away from cooking and heat sources.
  - Keep pot handles turned in.
  - Keep grills, fans and cooking surfaces free of grease residue.

- Electric blankets**
- Turn on no more than 30 minutes before bed.
  - Turn off before you get into bed.
  - Remove heavy items from bed when on.
  - Keep flat with controls at the side of the bed.
  - Regularly check for broken and worn wiring.

- Open fire place**
- Always use a fire screen in front of an open fire.
  - Put out fires before going to bed or going out.
  - Keep 1 metre clear space around

- Front door**
- Never deadlock doors when you're at home. If you must keep doors deadlocked, leave your keys in the lock.
  - Develop and practise your home fire escape plan – have two ways to escape each room and a designated safe meeting point outside your home, e.g. letterbox.

- Laundry**
- Clean the lint filter on your clothes dryer after each load.
  - Let the dryer complete its cooldown cycle before stopping.

### Remember...

- > If your smoke alarms have removable batteries replace them every year.
- > Supervise children near heating equipment.
- > Turn off electrical appliances at the power point when not in use.
- > Keep electrical appliances and equipment in good working order.
- > Replace damaged equipment e.g. power cords.
- > Don't overload power boards.
- > Have and know how to use your fire blanket and extinguisher.

[cfa.vic.gov.au/homechecklist](http://cfa.vic.gov.au/homechecklist)

## YOUR HOME FIRE ESCAPE PLAN



- > Draw your home floor plan in the grid and mark all the exits.
- > Identify two ways out of every room.
- > Decide on an outside meeting place, such as the letterbox.
- > Practise your home fire escape plan regularly with the whole family.
- > Keep this plan handy to remind everyone of the safe exits in case of fire.

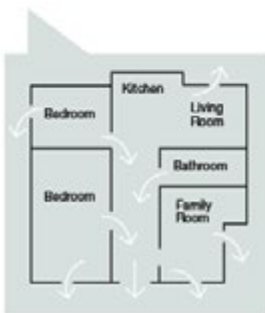

Version 2 - April 2010

[cfa.vic.gov.au](http://cfa.vic.gov.au)

# Textiles don't belong in your recycling bin.

Clothes, towels, linen and other textile items aren't accepted at the facilities that sort household recycling.

Consider giving away items that are in good condition, repurposing items that are damaged, or visiting a resource recovery facility to recycle textiles for free. If there's no other option, put them in your general rubbish bin.

A small act like recycling correctly makes a big impact.

**Find out more: [mrsc.vic.gov.au/recycling-bin](https://mrsc.vic.gov.au/recycling-bin)**



# A Welcome Sight, if You Are a Horse

ROMSEY'S 'BILLS WATER TROUGH' FOR HORSES C1930S



**This small piece of local rural history is located in Romsey's Main Street western service lane nature strip near the entry to the IGA car park. Peter Mitchell in his Romsey book 'A Veritable Garden of Eden' records that during the 1930s this water trough for horses was donated to the Romsey Township by George and Annis Bills.**

Seven hundreds of these horse troughs were placed around Australia mainly in Victoria and New South Wales during the 1930s. The troughs were pre-cast in concrete with a curved pediment with the inscription "Donated by Annis & George Bills Australia"

About 50 were also donated internationally, four of which survive in the UK. A rare Bills trough is in Tunbridge Wells others are in Englefield Green in northern Surrey, Hinckley Road in Leicester, and in Tilehurst, Reading.

George and Annis Bills had no children, and following the death of George in 1927, a trust fund was set up, believed to be around £70 to £80,000. One of the purposes of the trust, as set out in George Bills' will, was to:

*"...construct and erect and pay for horse troughs wherever they may be of the opinion that such horse troughs are desirable for the relief of horses and other dumb animals either in Australasia, in the British Islands or in any other part of the world subject to the consent of the proper authorities being obtained..."*

In the 1930s each trough cost around £13 plus more for transport and installation onsite to a water supply.

Initially the troughs were individually designed and constructed, however by the early 1930s, J.B. Phillips, a relative of the Bills, became the head contractor. Working to a standard design he pre-cast in concrete the troughs in a facility in Auburn Road Hawthorn. With the increase of the car and truck transport, demand for the troughs declined and production ceased around 1946.



**I** By John Spring (Romsey & Lancefield Districts Historical Society)

Contact our local agents about buying  
or selling your next property.

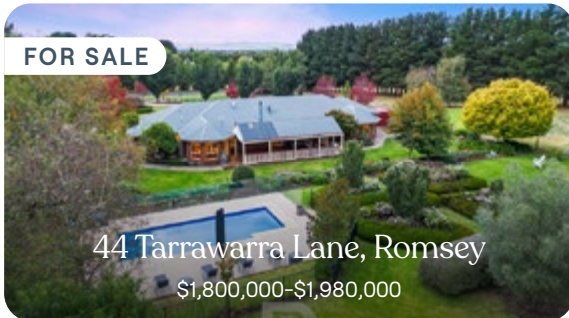

( RHYS NUTTALL )

0438 383 221  
rhys@boundrealestate.com.au

( LYNNE PAYNE )

0479 068 228  
lynne@boundrealestate.com.au

( PAUL BOHAN )

0413 594 224  
paul@boundrealestate.com.au

( DAMIEN WALDER )

0439 391 569  
damien@boundrealestate.com.au

( CAROLYN RYAN )

0407 393 079  
carolyn@boundrealestate.com.au

( SHANTELL CARDWELL-SMITH )

0421 217 582  
shantelle@boundrealestate.com.au